

(Opp.) New Survey South part 1st sq. 5th square

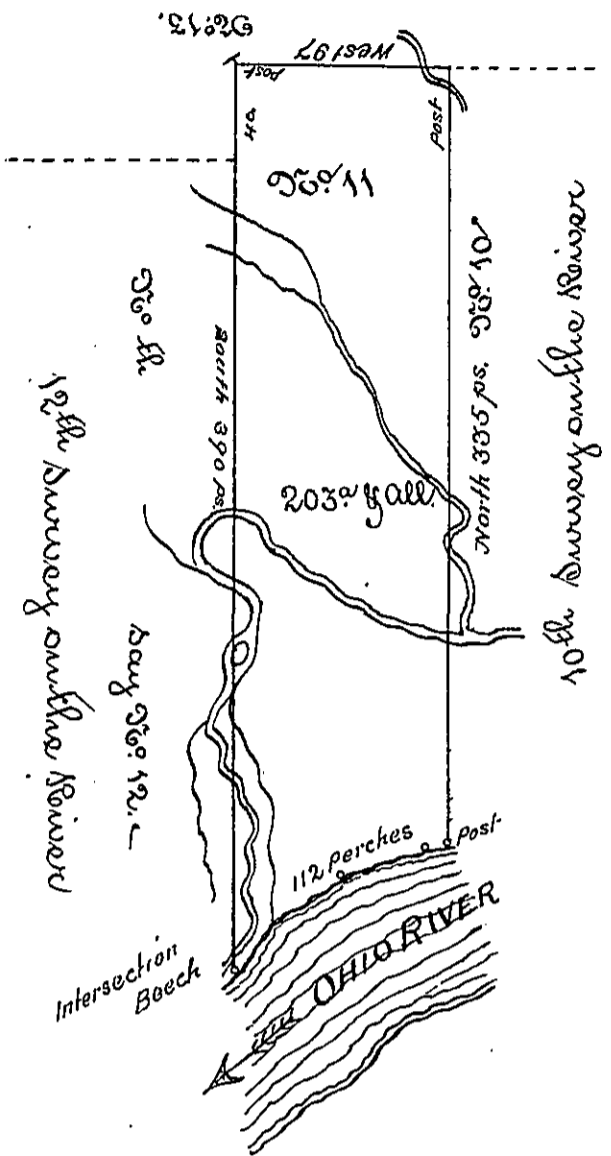

Situated on the North of Wolf Run being the 11th Survey adjoining the River Ohio in the second parallel of the 5th square in District Number 1 in that Tract of Country appropriated by law for the Redemption of the Certificates of Depreciation &c Surveyed in the Month of June 1785 pursuant to Instructions

To John Lukens Esquire
Surveyor General

By Alexander McLean Dep

IN TESTIMONY that the above is a copy of the original remaining on file in the Department of Internal Affairs of Pennsylvania, made conformably to an Act of Assembly approved the 16th day of February, 1833, I have hereunto set my Hand and caused the Seal of said Department to be affixed at Harrisburg, this first day of December 1896

James W. Latta
Secretary of Internal Affairs.